

INSTRUCTION MANUAL FOR MAFEX POTATO

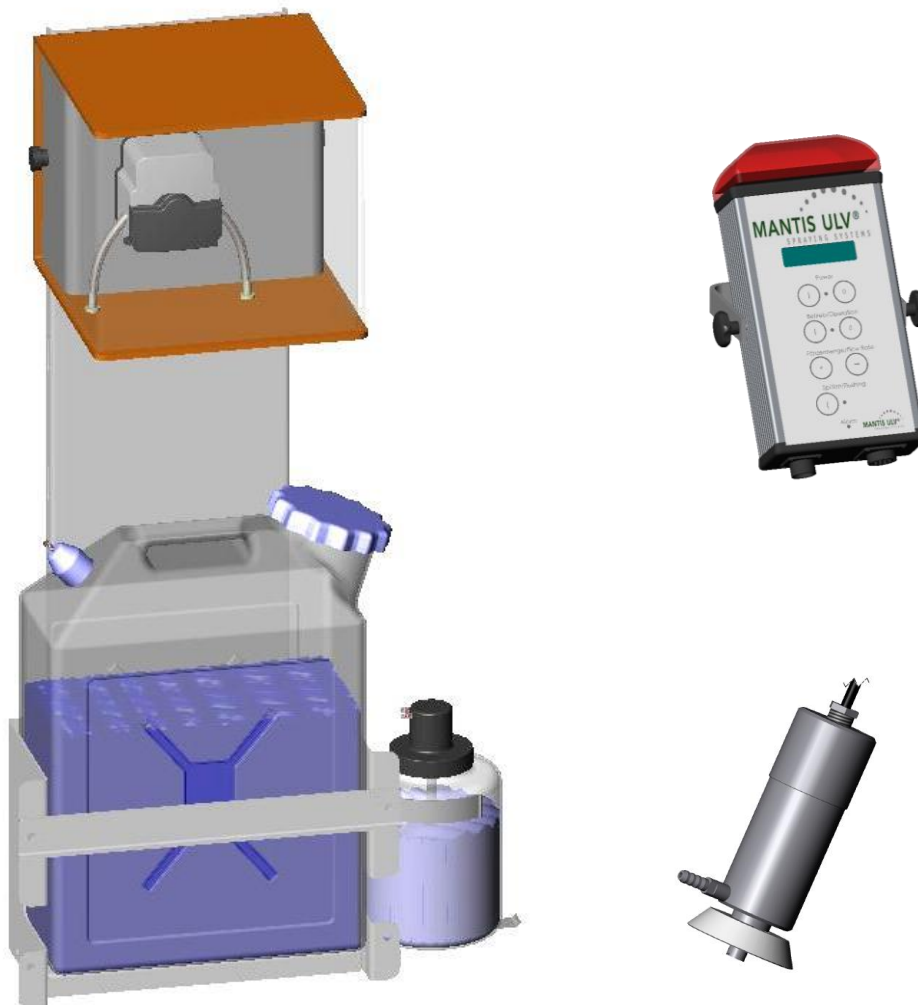

Manufacturer:

Mantis ULV-Sprühgeräte GmbH

Germany 21502 Geesthacht, Vierlander Str. 11 a

Telephone +49(0)4152-8459-0, FAX +49(0)4152-8459-11

Web: www.mantis-ulv.com Email: mantis@mantis-ulv.com

For safety reasons:

Keep the electric circuit zero potential for assembly. Prevent unintentional resetting



Important!

Periodic cleaning of the device is essential for a failure-free operation

- Check water-level in flushing tank periodically and refill it if necessary
- Religiously cleaning of the ULV dosing system after each use according to description on page 12.



Attention!

Never clean components of the ULV dosing device with a high-pressure cleaner or a sharp water jet.

The electronic components could be destroyed.



Operation of ULV dosing device	5
Preparation	5
Start-up	5
Mix the concentrate	6
Mixing example:	7
System check.....	7
Reverse pumping of the preparation	7
Scope of delivery	8
Assembly	9
Cleaning	12
Malfunctions.....	13



These operating instructions must be carefully and thoroughly read prior to installation or initial commissioning.

This unit:

- Was designed for the application of liquids against storage disease and germination inhibiting.
- Was designed for a supply voltage of 12 V to 17 V with compensation for natural fluctuations in the supply voltage of $\pm 5\%$.

Advantages of the MAFEX Potato/Fruit dosing unit:

- Liquid dosing without the use of additional amounts of water
- Differing application volumes according to hose variants:

Hose Ø	ml/min.	ml/h
3,2 mm	6,7 - 55	400 - 3300
4,8 mm	10 - 114	600 - 6850
8,0 mm	25 - 220	1500 - 13200

- Concentrate is applied as spray mist
- Maximum application duration due to 2x10l interchangeable tanks or an extra 31 l tank
- Simple and precise regulation
- Flow control and nozzle monitoring
- Nozzle flushing function
- Active indication of the applied volume

Assembly/Installation

Install all components according to the installation instructions on the following pages.

Ensure the kink- and twist-free positioning of the hoses and cables during installation.

Perform a function and leak test prior to initial deployment!

Operation of ULV dosing device

Preparation

- Fill the container with pre mixed concentrate according to the manufacturer's instructions.
- Fill the container of the cleaning system with tap water.
- Define the required application rate (It depends on the concentration of your mixed liquid, example see next chapter)

Start-up

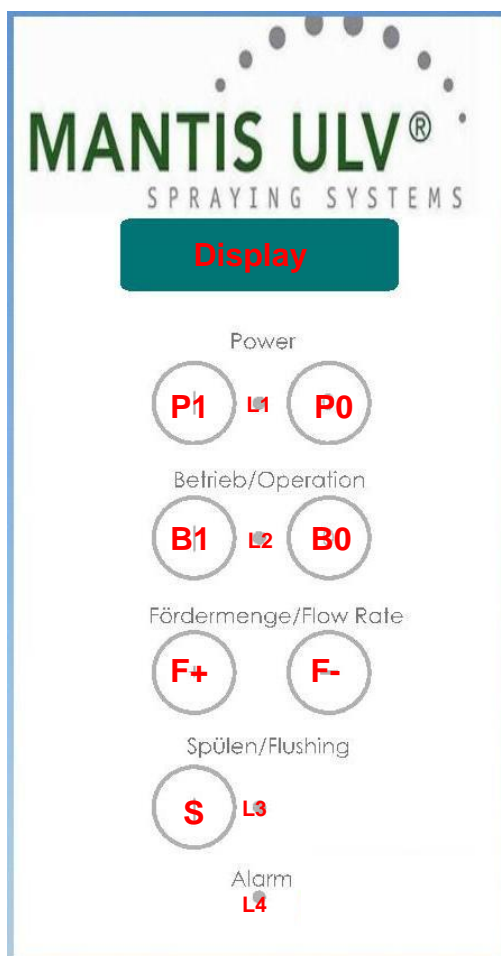

Switch-on the ULV dosing device by pushing button P1. Revision number is shown shortly and the connected components are initialised.

Before starting the system it is possible to delete the saved total output quantity by pressing the Flow Rate “+” button. By pressing the Flow Rate “-” button the mixture will be pumped reverse.

To start application push button B1. If the system is equipped with a flow control, mixture is pumped to the atomiser in maximum 90 seconds. After that the system switches automatically to operation mode.

Press button F+ or F- to adjust the desired application quantity. The current application quantity per atomiser is shown in the display.

To stop application e.g. during breaks, press button B0.

Furthermore the atomiser should be cleaned with water during short breaks by pushing button S for approx. 3 seconds. **LED L3** is glowing during flushing.

LED L4 is glowing if there is an error (e.g. no mixture in the container). Please have a look at the chapter on page 11 for **troubleshooting**.

Attention: Use only mixtures according to manufacturer's instructions! Other, untested liquids with other viscosities, boils etc. might cause fatal errors.

Mix the concentrate

Chlorpropham - Liquids (300g/l Chlorpropham, EC-Formulation)					ml/t
Gro-Stop Basis (Certis/Spiess-Urania)		60ml/t in 140 ml water			200
Neonet Start (Belchim)		60ml/t in 140 ml water			200
Neo-Stop Starter (Stähler)		dto.			
Copper hydroxid - Liquids (460,6 g/l Copper Hydroxide, SC-Formul.)					
Cuprozin liquid (Spiess-Urania)		160ml/t in max 5% water			168
Imazilil-Liquids (100 g/l Imazilil, water soluble conc.)					
Fungazil 100 SL (Certis/Spiess-Urania)		150 ml/t in 150 ml water			300
Pencycuron - Liquids (Pencycuron 249,6 g/l, SC-Formulation)					
Monceren Flüssigbeize (Bayer)		600 ml/t			600

No responsibility is taken for the correctness of the details provided

Mixing example:

If there are 20 tons of potatoes which should be stored in 60 min and should be treated with an application rate of 200ml per ton you need the following pump capacity:

$$\frac{20t}{60\text{min}} * \frac{200ml}{1t} = 67 \frac{ml}{\text{min}} = 4020 \frac{ml}{h}$$

System check

Set the chemical solution volume according to your calculations and run the system for 15 minutes.

Collect the chemical solution for one minute into a measuring cup.

If the desired volume is not reached, please check the seat and adjustment of the hose.

After one hour work the nominal value should be compared with the volume which was pumped out of the container.

Reverse pumping of the preparation

Keep the F- button pressed, until all fluid from atomiser to the tank is pumped reverse.

Scope of delivery

Included with the MAFEX-SYSTEM are:



Control box 102396

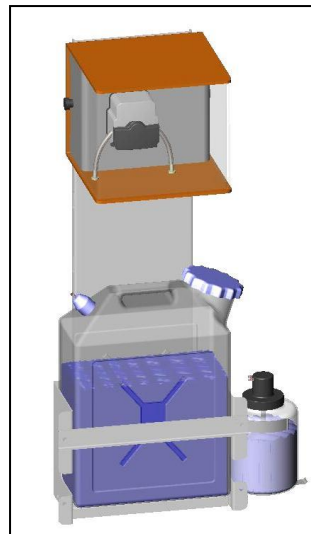

Pump unit MAFEX Potato 2013 103496
Flushing pump with tank 100988
10 l tank 102564
Mounting frame for MAFEX 102628



Atomiser B-M/4 104030



Power supply unit 110 Volt/15 V 102839
Power supply unit 230 Volt/15 V 105085

Various hoses and cable without figure.

Optional:

- Flow control device MAFEX-Potato/1 102658
- Flow control device MAFEX-Potato/2 102659
- Flow control device MAFEX-Potato/3 102669
- Flow control device MAFEX-Potato/4 102670
- 31 l tank 102608

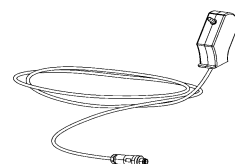

Assembly

Control unit:

The control unit should be mounted with the prescribed bracket in a position highly visible during operation.

Attention!

Pump unit and power supply should not be mounted in a dusty humid surrounding area

Pump unit:

The pump unit should be mounted next to the canopy.
Make sure that the concentrate tank can be easily removed.

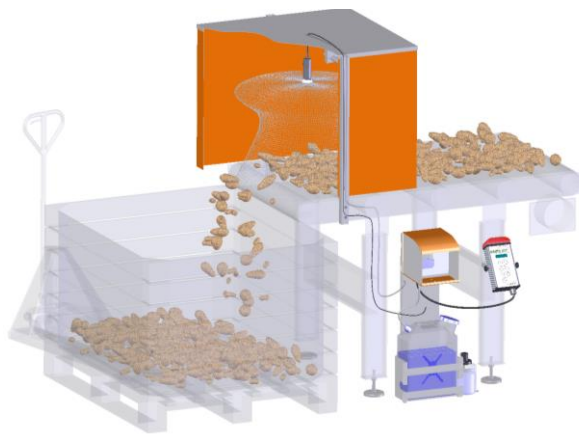

Assembly example for control- and pump unit

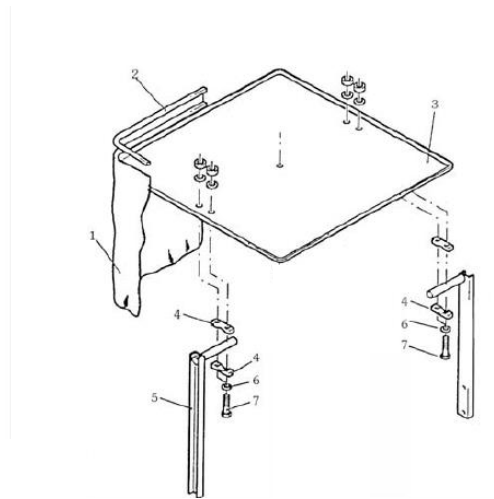

Atomiser:



Assembly example for atomiser



Cable and hose connections

After installation of the control box, pump unit and atomiser the cable and hose connections have to be fixed. Please pass the hoses and wires free of twists.

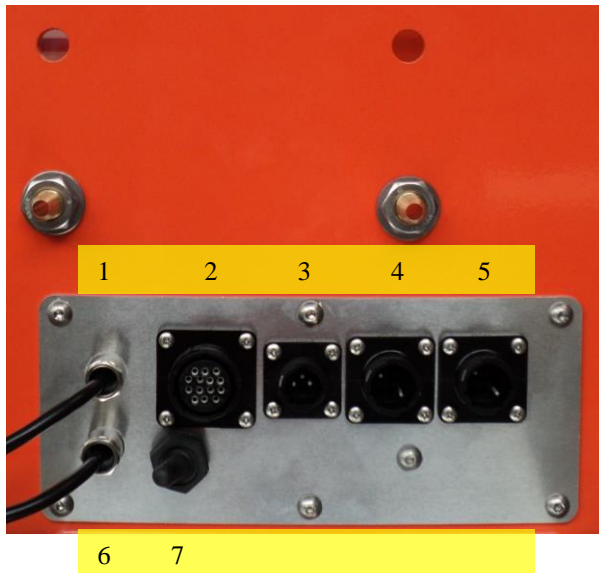
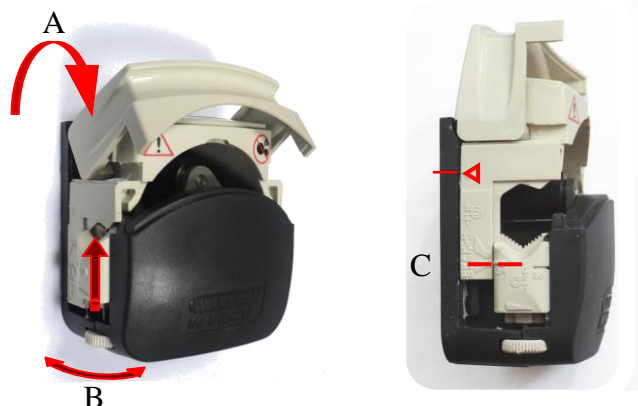

fig.: pump unit (bottom view)

- 1) Cable for AGA signal
- 2) Connection control box
- 3) Connection flow control
- 4) Connection atomiser
- 5) Connection atomiser
- 6) Cable for flushing pump
- 7) Selector switch for AGA signal

Peristaltic pump

By turning the quick release fastener (A) the hose can be inserted/replaced. The hose has to be fixed by the hand wheel (B). The standard hose 4,8mm x 1,6mm for 600ml/h up to 6850ml/h has to be fixed in position (C).



If the hose locking device is set on a too small diameter the pump performance will be reduced and the output is too low. In this case the total pump output "T-Vol" shown in the display will deviate from the actual capacity

Function & connection of the AGA

The control wire of the conveyor belt has to be connected with the relay of pump unit. This relay is an NO/NC type. To choose whether the circuit should be “Normally Open” or “Normally Closed” use the selector switch S1

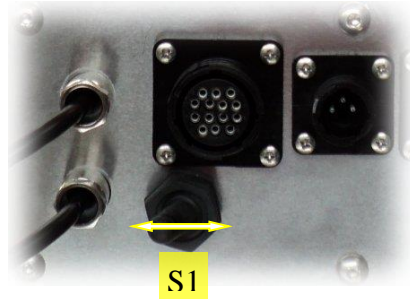
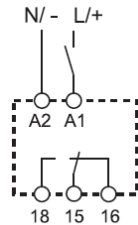

The switching voltage of the multifunction relays is between 12-230V AC or DC

For your personal safety make sure that the pump box is earthed when you are working with voltage over 60 V DC or 25 V AC to earthed.

Flow control (optional)

The flow control unit should be installed next to the atomiser.



For testing the flow control some salt should be added to the water to raise conductivity of the fluid.

Nozzle monitoring function & connection

The nozzle monitoring function is integrated into the controller. The monitoring function ensures the proper operation of the nozzle motor. Permanent current monitoring checks whether the nozzle is connected to the system or if it is operating in the overload range. An alarm will be triggered if the nozzle is not connected to the system, due to cable breakage or clogging of the atomiser, for example.

THIS FUNCTION DOES NOT REPLACE THE REGULAR INSPECTION OF THE NOZZLE ATOMISER DISC!

Cleaning

A religiously cleaning of the system after use at the end of the day is essential.

How to clean the atomiser on the job (in short brakes):

1. Stop the dosing process by pressing the operation „0“ button.
2. Check filling level of the flushing tank
3. Press the „Flushing“ button to start the flushing process
4. Press and hold the Flushing button at least **3 seconds**.

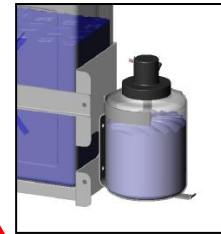

Flushing pump, tank



Control box

For a religiously cleaning of the system after use at the end of the day the 10l/30l tank has to be cleaned and filled with fresh water.

1. Now restart the system for three minutes. If the flow control gives an alarm message in these three minutes please restart the system.



Winter storage

For the storage in wintertime please make sure that there is no water left in the system (hoses, tank, pump, and atomizer). Don't use any anti-freezing agent. Store the system in dry conditions above the freezing temperature.

Malfunctions

If malfunctions occur due to neglect of the cleaning requirements, constituting improper usage, proceed as follows:

1. Check the suction lance for clogging and the connection hose for proper seating.
2. Remove the hose from the flow controller and clean the sensor with water.
3. Dismantle the front side of the nozzle and remove the nozzle atomiser disc from the motor shaft. Thoroughly clean all components with a brush.

Fault	Possible cause	Remedial action
The display does not indicate a value	Voltage is below 11.5V or no supply voltage applied	Check the plug connections as well as the voltage
The display depicts „Flow sensor error“	Preparation is no longer conveyed due to a defective hose or an empty tank	Check the hoses as well as the tank fill charge
The dosing pump does not turn	No supply voltage applied	Check the control line plug connections (grey cable)
	The relay does not provide the correct signal	Swap the connections from 3 and 4 to 1 and 2.
The flush pump is not functioning	No supply voltage applied	Check the plug connections as well as the voltage
The display indicates „Nozzle alarm“	No supply voltage applied or current draw too high	Check the plug connections, check whether deposits are clogging the nozzle/nozzle atomiser disc
	The nozzle is defective	The nozzle must be replaced
The selected pump capacity does not correspond to the application volume	The pump hose is defective or not properly installed, or the system has a leak	Check all hose connections

Spare parts

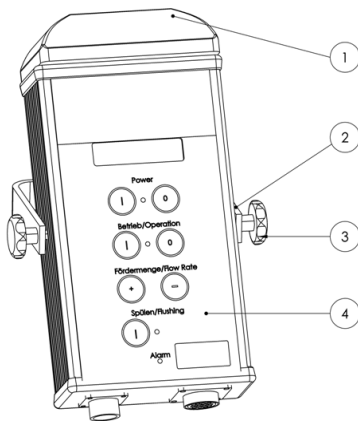

Part	Art.No.	Description
------	---------	-------------

102396 Control box, MAFEX 2010

1	102747	Alarm siren with flash light, red ,12V
2	103125	Bracket for controll box MAFEX 2010
3	100861	Star-shaped clamp screw
4	102434	Membrane keyboard, MANTIS Logo

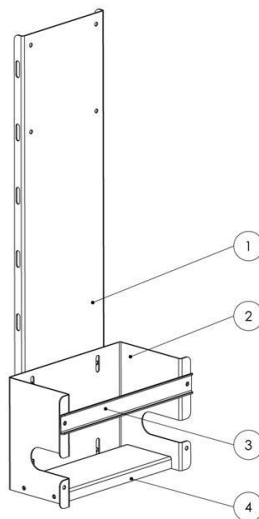

Part	Art.No.	Description
------	---------	-------------

102628 Mounting frame for MAFEX

1	103119	Bracket for pump unit, Mafex 2010
2	103120	Bracket for 10l tank, Mafex 2010
3	103122	Lock bar for mounting frame, Mafex 2010
4	103121	Baseplate for mounting frame, MAFEX 2010
5		Screw set for mounting frame MAFEX 2010

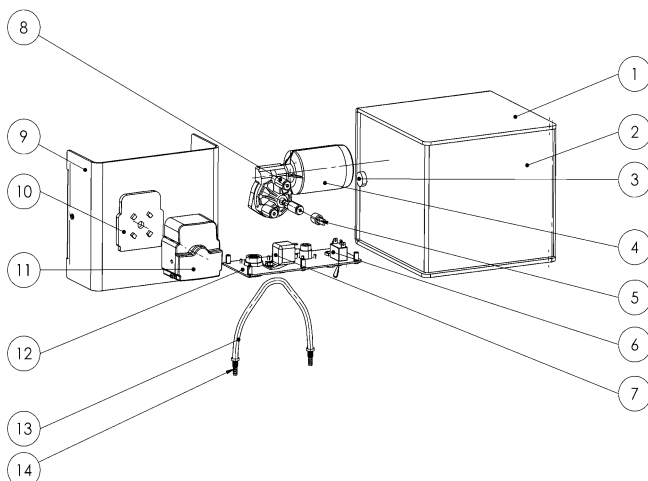

Part	Art.No.	Description
------	---------	-------------

103496 Pump unit MAFEX POTATO 2013

1	103489	Housing, pump unit, MEFEX 2013
2	103491	Window, housing for pump unit, MAFEX
3	100233	Knurled screw M 5 x 10 mm
4	100177	Pump motor 12 V with Hall-Sensor
5	102876	Coupling for motor, WM, hose pump
6	103495	Toggle Switch for MAFEX AGA/Pick-Up
7	102610	Relay 12V, NC / NO
8	102807	Distance piece for motor, MAFEX 2010 pump unit
9	103490	Mounting plate for pump, pump unit, MAFEX
10	102932	Mounting plate for hose pump
11	102873	Peristaltic Pump Head, 3-rollers pump head
12	103494	Connector plate for pump housing, MAFEX
13	102805	Hose, MAFEX, 3,2 mm, 6,7-55 ml/min. for WM.
13	102806	Hose, MAFEX, 4,8 mm, 10-114 ml/min. for WM.
13	102818	Hose, MAFEX, 8,0 mm, 25-220 ml/min. for WM
14	102928	Hose lead-through 4,0mm-6,5mm
14	102871	Hose lead-through 4,0mm-9,0mm
14	102930	Hose lead-through 6,5mm-6,5mm
14	102870	Hose lead-through 9,0mm-6,5mm
14	102860	Hose lead-through 9,0mm-9,0mm
15	101576	hexagon nut, thin type M12

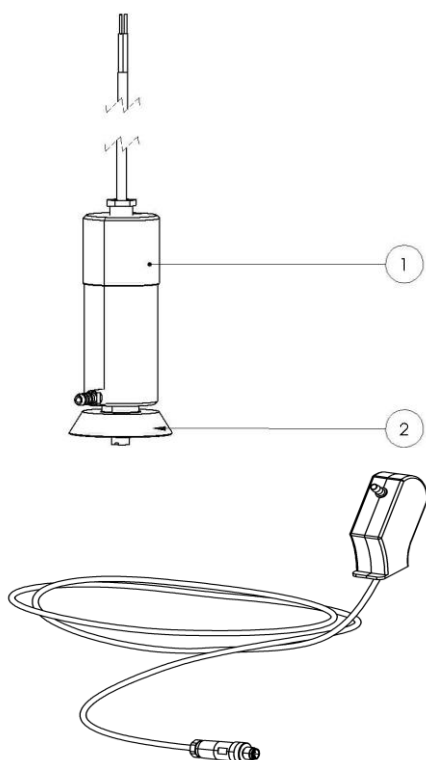

Part Art.No. Description

104030 Atomiser with motor type B-M/4

1	104036	Motor-module for atomiser type B-M/4
2	100120	Atomiser disc type BL and B-M/4

Part Art.No. Description

102658 Flow Control-MAFEX/1

102659 Flow Control-MAFEX/2

102669 Flow Control-MAFEX/3

102670 Flow Control-MAFEX/4

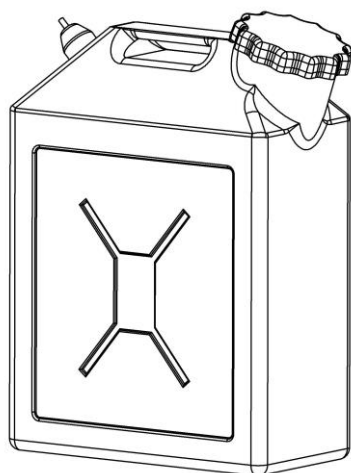

Part Art.No. Description

102564 Tank, capacity 10 litre for MAFEX 2010

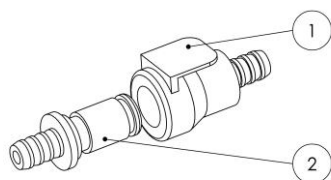

Part Art.No. Description

102949 Quick release coupler APC, compl.

1	102947	Quick release coupler
2	102948	Quick release coupler-plug

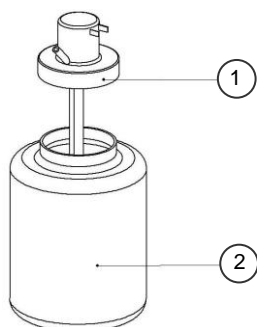

Part Art.No. Description

100988 Flushing pump with tank

1		Flushing pump
2		Tank

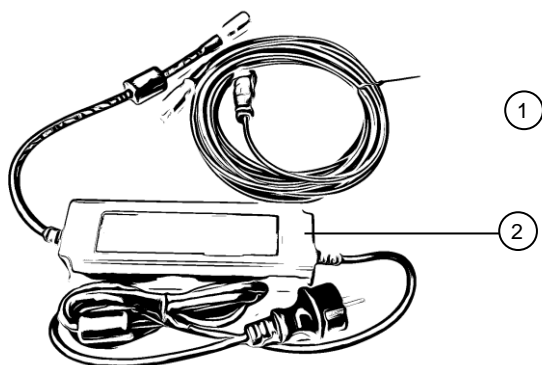

Part Art.No. Description

105085 Power supply unit 230V - 15V 8A, MAFEX 2020

1	105084	Cable, power supply, MAFEX 2020
2	105059	Power supply 200-240V - 15V 8A, MAFEX 2020

Part Art.No. Description

Without pic.

100839 Atomizer cable with AMP-plug

Without pic.

100774 Control lead, 5 m, 2-plug (AMP) 14-pol.

Without pic.

102847 Control lead, 10 m, 2-plug (AMP) 14-pol.

Without pic.

102621 Hose kit, 3,2 mm with connector

Without pic.

102622 Hose kit, 4,8 mm with connector

Without pic.

102623 Hose kit, 8,0 mm with connector

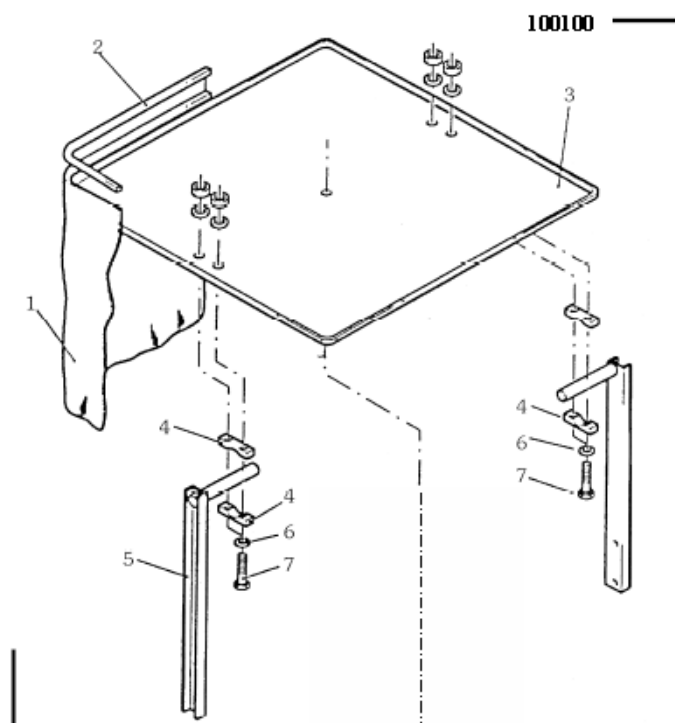

104030

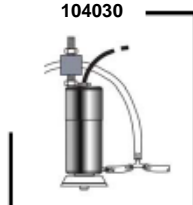

Item Part No. Description

100100 Canopy 80 x 80 cm complete, for 1 atomiser

1	100093	Curtain
2	100094	Clamp profile
3	100099	Canopy only, 80x80 cm
4	100096	Clamp
5	100095	Mounting leg
6	101417	Washer M 8, 8,4 mm
7	101127	Screw M 8 x 60 mm
	104030	Atomiser with motor type B-M/4 and shock absorber

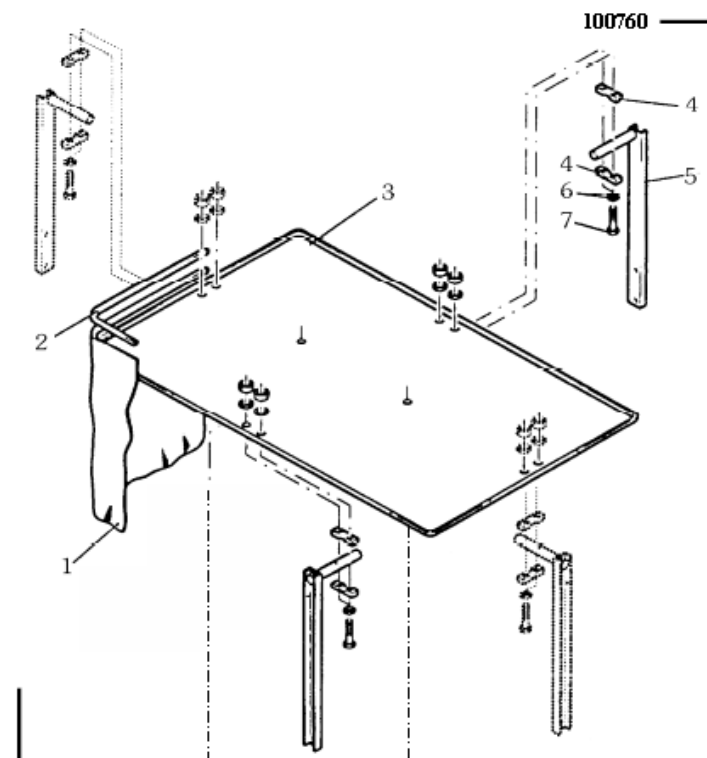

104030

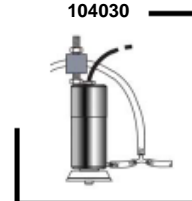

104030

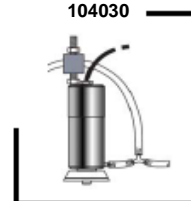

Item Part No. Description

100760 Canopy 120x80 cm complete, for 2 atomisers

1	100758	Curtain
2	100759	Clamp profile
3	100761	Canopy only, 120x80 cm
4	100096	Clamp
5	100095	Mounting leg
6	101417	Washer M 8, 8,4 mm
7	101127	Screw M 8 x 60 mm
	104030	Atomiser with motor type B-M/4 and shock absorber

Electrical connections of the MAFEX-ULV-Systems

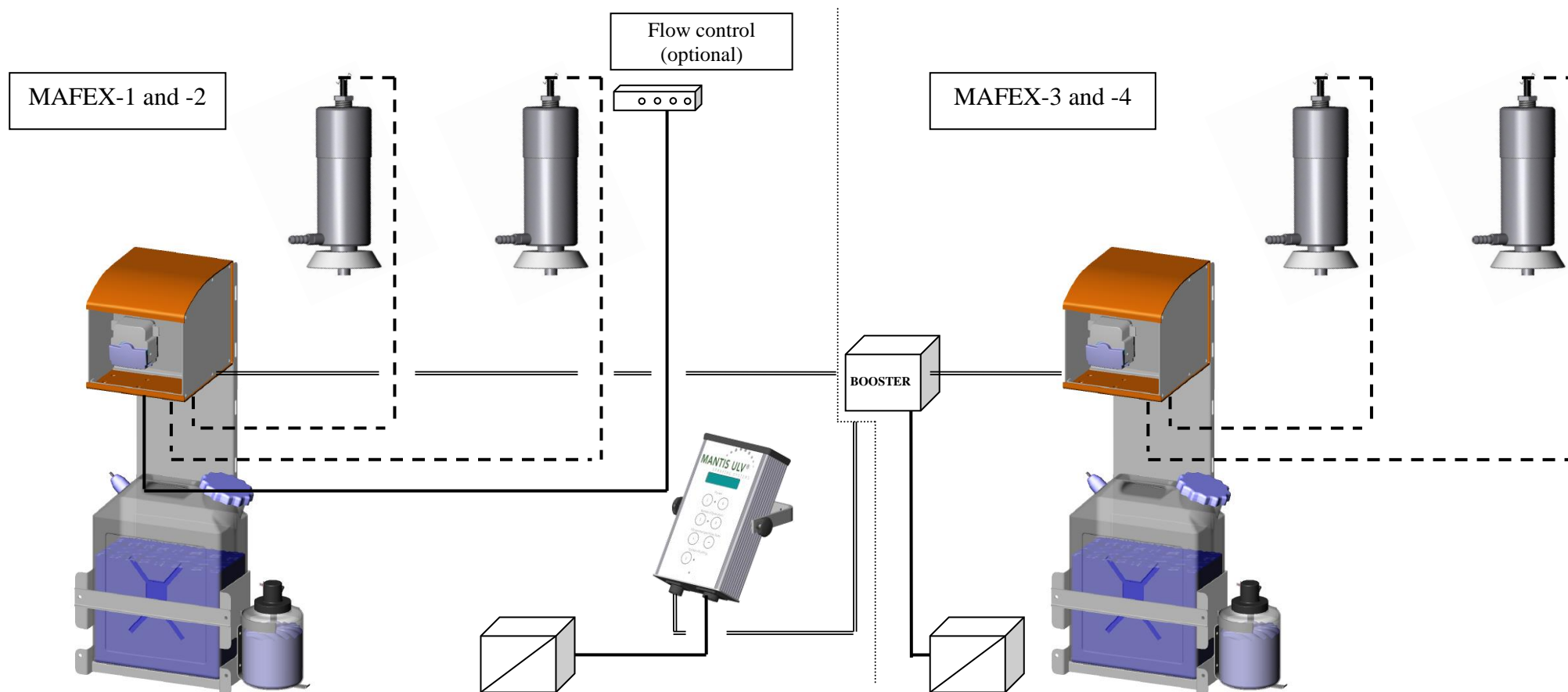

Mantis ULV-Sprühgeräte GmbH

Germany 21502 Geesthacht, Vierlander Str. 11 a

Telephone +49(0)4152-8459-0,

FAX +49(0)4152-8459-11

Web: www.mantis-ulv.com

Email: mantis@mantis-ulv.com

Hose connections of the MAFEX-ULV-Systems

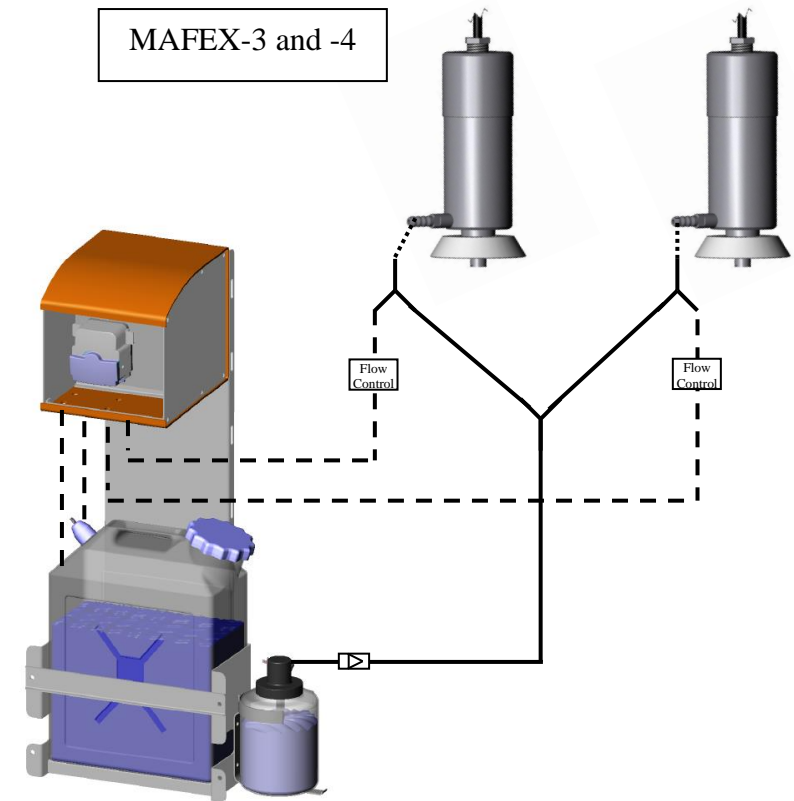
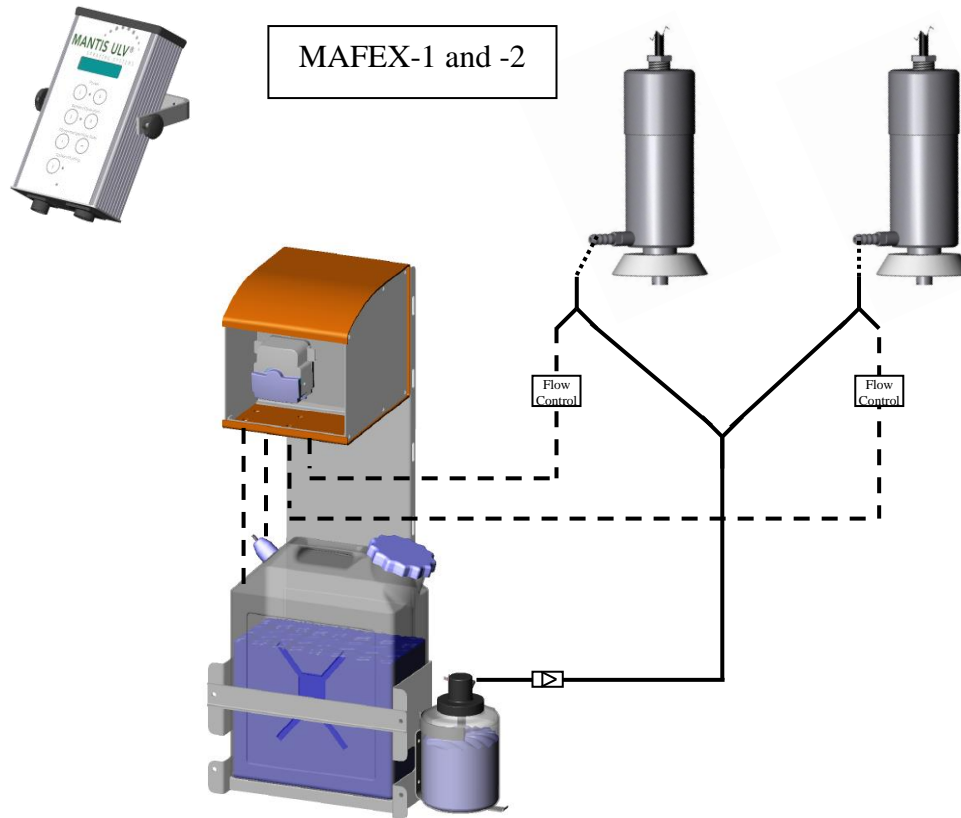

Mantis ULV-Sprühgeräte GmbH

Germany 21502 Geesthacht, Vierlander Str. 11 a

Telephone +49(0)4152-8459-0,

FAX +49(0)4152-8459-11

Web: www.mantis-ulv.com

Email: mantis@mantis-ulv.com

EG-Declaration of conformity

Council Directive 2006/42/EG

Mantis ULV-Sprühgeräte GmbH, Vierlander Straße 11 a, 21502 Geesthacht declare under our sole responsibility that the following products are in conformity with the provisions of the following Council Directive: 2006/42/EG

Typ MAFEX

Geesthacht January 2021

(Place and date of signature)

Hiske Weissmann
Managing Director



(Name, title and signature)